

A
I
Z
U
BERES
MENS





Lush greens. Rolling hills.
The musical twang from the force of a swing.
The quiet roll of an expert putt.

LOOK GREAT
PLAY GREATER



ARMQRQ MX SHAFTS
ARMQRQ MX shafts are Made in Japan using the highest quality materials at Honma Golf HQ in Sakata. Featuring proprietary designs using NEW 10 Axis Sheet Metal Hybrid Armour Technology (4-Axis Aluminum and 6-Axis Carbon) to deliver Counter-Balance designs for added clubhead speed, along with industry leading Toray Composite M40X* and T1100G Carbon, ARMQRQ shafts deliver progressively faster speed and added control as players progress from 2-Star, through to 5-Star offerings
*M40x available in 3+ Star BERES

TECHNOLOGY



TRIPLE SOLE SLOTS
Featuring NEW Triple Sole Slot, Thin Crown Design, a Thin and Flexible Face, and Low-CG weight distribution designed independently for each head, BERES Drivers offers unprecedented distance through ample speed, high launch trajectory, and easy-to-play draw-biased forgiveness.

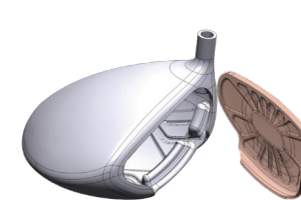

RADIAL L-CUP FACE
NEW Radial L-Cup Face, NEW Triple Sole Slot, and NEW Ti811 Thin Crown Design combine to offer the very best in BERES speed, high-launch, low-spin performance with added draw bias for more forgiveness.

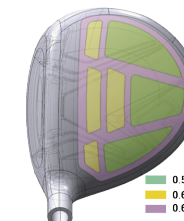

Ti811 THIN CROWN DESIGN
Weight saved from the crown is used to optimize center of gravity location and enables High-Launch, Low-Spin, Draw-Bias and Forgiveness.

SPECIFICATIONS

CLUB	1W		
LOFT(deg.)	9.5°	10.5°	11.5°
LIE (deg.)	60°		
HEAD VOLUME (cc)	460°		
LENGTH (inch)	46"		
SHAFT	ARMQRQ MX		
SWINGWEIGHT R2 / 42g	D1	D1	D1
R / 44g	D1	D1	D1
SR / 47g	D2	D2	D2
S / 50g	D2	D2	D2
ARMQRQ MX DYNAMIC			
R / 49g	D1	D1	D1
SR / 52g	D2	D2	D2
S / 55g	D2	D2	D2

Golf is strength and beauty combined. No other sport allows us golf's opportunity to savor surroundings, choose tools thoughtfully, and fully reflect on the power of our movement in competition.





BERES | AIZU



ARMQR MX SHAFTS
ARMQR MX shafts are Made in Japan using the highest quality materials at Honma Golf HQ in Sakata. Featuring proprietary designs using NEW 10 Axis Sheet Metal Hybrid Armour Technology (4-Axis Aluminum and 6-Axis Carbon) to deliver Counter-Balance designs for added clubhead speed, along with industry leading Toray Composite M40X+ and T1100G Carbon, ARMQR shafts deliver progressively faster speed and added control as players progress from 2-Star, through to 5-Star offerings
.*M40x available in 3+ Star BERES

TECHNOLOGY



TRIPLE SOLE SLOTS
Featuring NEW Triple Sole Slot, Thin Crown Design, a Thin and Flexible Face, and Low-CG weight distribution designed independently for each head, BERES Fairways offers unprecedented distance through ample speed, high launch trajectory, and easy-to-play draw-biased forgiveness.

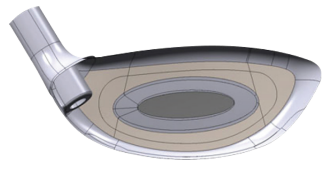

FLEXIBLE FACE INSERT
A thin and flexible hardened steel face insert provides improved Ball-Speed for meaningful distance and strong trajectory.



LOW CG DESIGN
Center of Gravity of each head is Flow Designed by loft to ensure each Fairway Wood delivers optimal trajectory from a wide variety of turf conditions.

SPECIFICATIONS

CLUB	3W	5W	7W
LOFT(deg.)	15°	18°	21°
LIE (deg.)	59.5°	60°	60.5°
HEAD VOLUME (cc)	185	174	165
LENGTH (inch)	43"	42.5"	42"
SHAFT	ARMQR MX		
SWINGWEIGHT R2 / 42g	D0	D0	D0
R / 44g	D0	D0	D0
SR / 47g	D1	D1	D1
S / 50g	D1	D1	D1
SHAFT	ARMQR MX DYNAMIC		
R / 49g	D0	D0	D0
SR / 52g	D1	D1	D1
S / 55g	D1	D1	D1

BERES AIZU collectible product line creates equipment equal to this high standard—and your expectations.

Whether you're a master, a pleasure player, or a beginner, BERES AIZU sets you and your game apart.





BERES | AIZU



ARMQR MX SHAFTS
ARMQR MX shafts are Made in Japan using the highest quality materials at Honma Golf HQ in Sakata. Featuring proprietary designs using NEW 10 Axis Sheet Metal Hybrid Armour Technology (4-Axis Aluminum and 6-Axis Carbon) to deliver Counter-Balance designs for added clubhead speed, along with industry leading Toray Composite M40X+ and T1100G Carbon, ARMQR shafts deliver progressively faster speed and added control as players progress from 2-Star, through to 5-Star offerings .*M40x available in 3+ Star BERES

TECHNOLOGY



TRIPLE SOLE SLOTS
Featuring NEW Triple Sole Slot, Thin Crown Design, a Thin and Flexible Face, and Low-CG weight distribution designed independently for each head, BERES Hybrids offers unprecedented distance through ample speed, high launch trajectory, and easy-to-play draw-biased forgiveness.

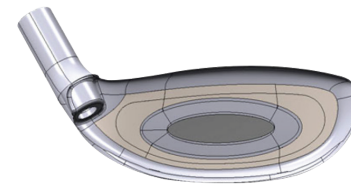

FLEXIBLE FACE INSERT
A thin and flexible hardened steel face insert provides improved Ball-Speed for meaningful distance and strong trajectory.



LOW CG DESIGN
Center of Gravity of each head is Flow Designed by loft to ensure each Utility delivers optimal trajectory from a wide variety of turf conditions.

SPECIFICATIONS

CLUB	U19	U22	U25	U28
LOFT(deg.)	19°	22°	25°	28°
LIE (deg.)			60	
HEAD VOLUME (cc)		133		
LENGTH (inch)	40.5"	40"	39.5"	39"
SHAFT		ARMQR MX		
SWINGWEIGHT	R2 / 42g	D0	D0	D0
	R / 44g	D0	D0	D0
	SR / 47g	D1	D1	D1
	S / 50g	D1	D1	D1
		ARMQR MX DYNAMIC		
	R / 49g	D0	D0	D0
	SR / 52g	D1	D1	D1
	S / 55g	D1	D1	D1

Delivering Japanese master craftsmanship, the artistry of Aizu, modern design, and all-new performance features that elevate your power of play ... BERES AIZU represents the strength and beauty of golf—and what you bring to the golf experience.





BERES AIZU



ARMQR MX SHAFTS
ARMQR MX shafts are Made in Japan using the highest quality materials at Honma Golf HQ in Sakata. Featuring proprietary designs using NEW 10 Axis Sheet Metal Hybrid Armour Technology (4-Axis Aluminum and 6-Axis Carbon) to deliver Counter-Balance designs for added clubhead speed, along with industry leading Toray Composite M40X and T1100G Carbon, ARMQR shafts deliver progressively faster speed and added control as players progress from 2-Star, through to 5-Star offerings.

TECHNOLOGY

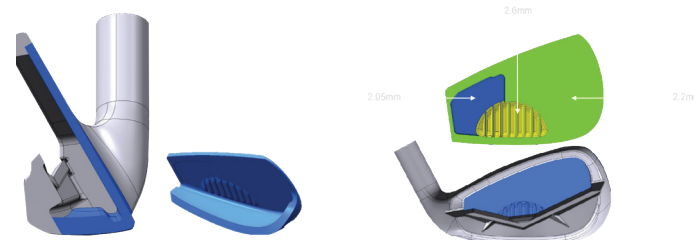

WIDE 3-D L-CUP FACE INSERT
Featuring a wide L-Cup Design utilizing New Ultra-Thin Face which uses Vertical Slits specifically arranged to improve the strength of the face insert to allow for maximum speed and forgiveness. Coupled with one external and two internal sole slots, as well as a Low-Deep Center of Gravity, BERES Irons are easy to launch high with strong carry distance. An 8620 Forged Body delivers Honma's hallmark feel for the most discerning of players.

SPECIFICATIONS

CLUB	#5	#6	#7	#8	#9	#10	#11	AW	SW
LOFT(deg.)	21°	24°	27°	31°	35°	40°	45°	50°	55°
LIE (deg.)	61°	61.5°	62°	62.5°	63°	63°	63°	63°	64°
OFFSET(mm)	4mm	3.7mm	3.5mm	3.5mm	3.5mm	3.5mm	3mm	3mm	2mm
LENGTH (inch)	38.25"	37.75"	37.25"	36.75"	36.25"	35.75"	35.5"	35.5"	35"
SHAFT	ARMQR MX								
SWINGWEIGHT	R2 / 42g	C9	C9	C9	C9	C9	C9	C9	D0
	R / 44g	C9	C9	C9	C9	C9	C9	C9	D0
	SR / 47g	D0	D0	D0	D0	D0	D0	D0	D1
	S / 50g	D0	D0	D0	D0	D0	D0	D0	D1
ARMQR MX DYNAMIC									
	R / 49g	C9	C9	C9	C9	C9	C9	C9	D0
	SR / 52g	D0	D0	D0	D0	D0	D0	D0	D1
	S / 55g	D0	D0	D0	D0	D0	D0	D0	D1

